

BroadLink

RM2 User Manual

V2.0

Quick Setup

Step 1. Download BroadLink App:

- A. Download the free BroadLink App from the Apple App store or google play by searching for “BroadLink” or “e-Control”.
- B. Scan the QR Code from the packing box of the Broadlink RM2 to download and install Broadlink App.



- C. Visit at www.broadlink.com.cn by using your smartphone internet browser, and press “App Download” in the below page to download and install.

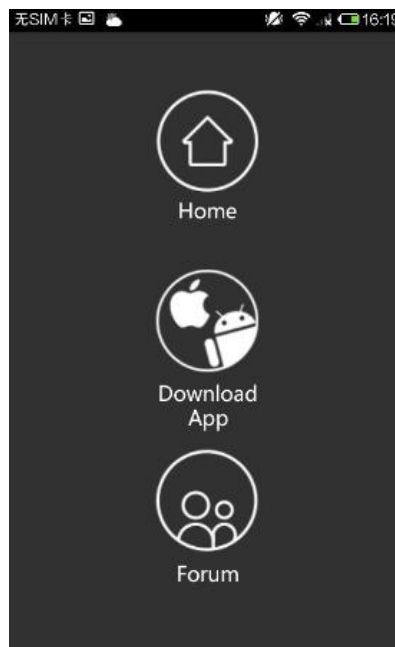

Step 2:

Plug RM2's power supply into a power outlet.

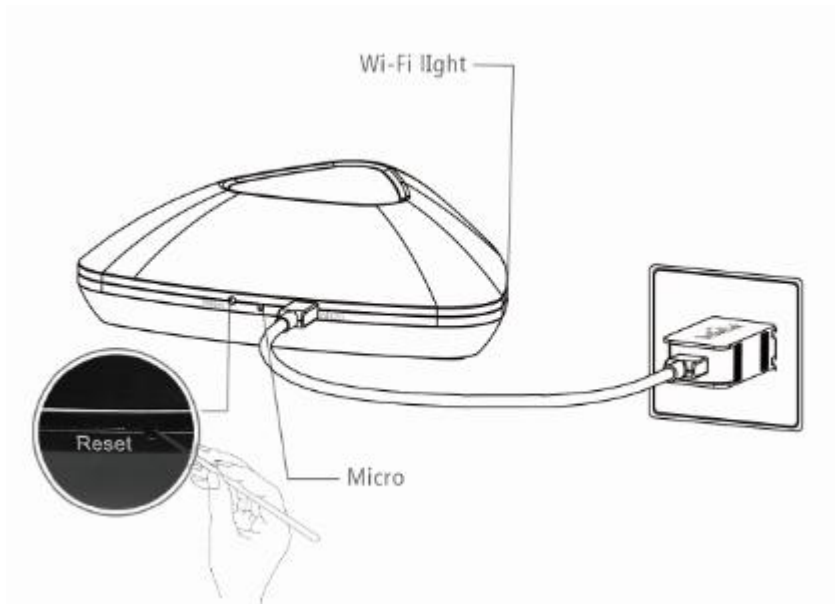

Step 3:

Ensure the blue light on RM2 is flashing rapidly at about 5-6 times per sec. Otherwise, please press reset button until the blue light is fast flashing.

Step 4:

Launch the e-Control App and start the setup.

Note: Before starting to setup the device, make sure your iOS/Android smartphone is connected to your home Wi-Fi network.



Press to start configure



Enter your Wi-Fi name (SSID)

Enter Wi-Fi password

Press to start configure

Fast flash at 5-6 times/sec

- I When first time launching Broadlink App, it will take you to the setup wizard.
- I Or, Tap "Add new device" button on System Setup menu. You can find system setup menu by swipe finger right on the main page.
- I Then, following setup instruction.

- I After setup, the flash of blue light will slow down to turn off, that means the device is successfully connected to the Wi-Fi network. You will also see the notice on the smartphone screen.
- I Swipe finger left of main page to see the device list.
- I RM2 should be listed there.



Functions

1. Add a device template to learn IR or 433/315 MHz signal.

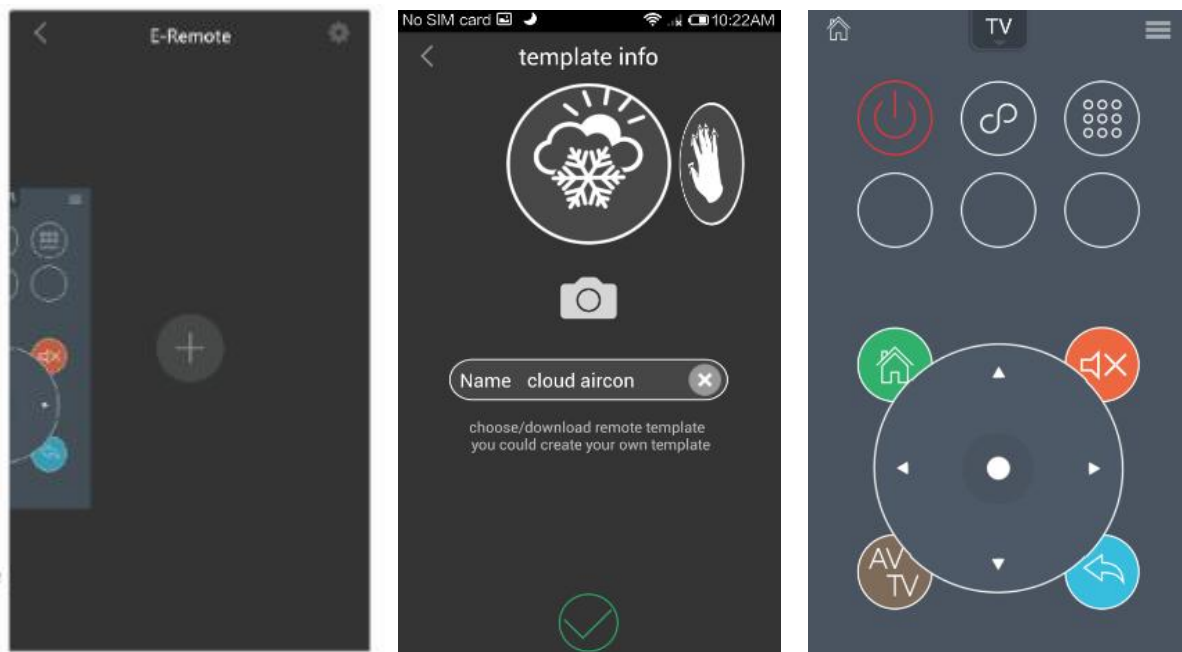

- I Tap RM2 device icon, then Tap add “+” icon
- I Then choose a template, you can name this device and give it a picture
- I Tap Ok
- I Go into the template, then tap any icon to learn the IR or 433/315 MHz control command.

Enjoy and try different device templates ...

2. Add a scene

- I Add a scene in the system setup menu.
- I Following the wizard, add picture and name the scene, add sequence of control command.
- I You can adjust the timing delay between the commands.

